



**A28/29** **Compact 100** – Floodlamp.  
**Compact 100 Leisure** – Floodlamp with magnet mounting.



**A30** **ASW 105** – Floodlamp, with option of switch and handle.



**A31** **Kiruna 140** – Floodlamp, with option of switch and handle.



**A32/33** **Pilot** – Floodlamps or spot lamps.  
**A34/35**



**A36** **ASW 140 x 65** – Floodlamps for extremely confined installation locations



**A37/38** **Touring** – Floodlamps and spot lamps, with option of switch and handle.



**A39** **Professional** – particularly robust floodlamp, with protecting grille.



# Floodlamps and spot lamps

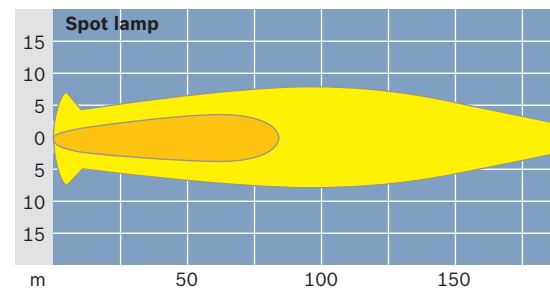
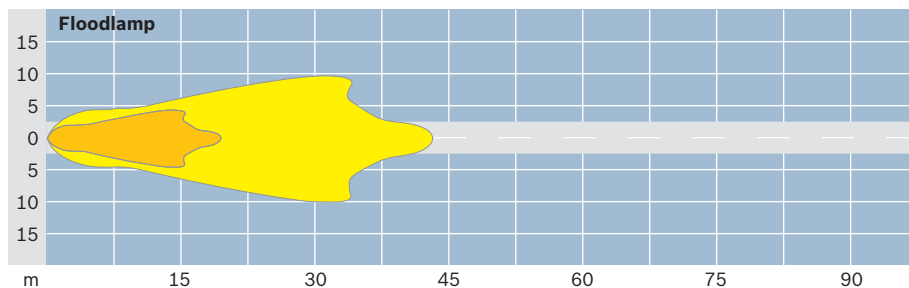

## Floodlamp

The floodlamp is used for illuminating stationary or mobile workplaces. Thanks to its heavy-duty design, the floodlamp is particularly suitable for mounting on commercial vehicles, and is thus versatile in its applications. Floodlamps are used above all in the construction industry, agriculture, forestry, transport, industry, the municipal services sector, emergency services and at sea.

**The floodlamp provides a wide, uniform beam of light, thus illuminating a large working area in the immediate vicinity.**

## Spot lamps

The spot lamp, with its concentrated beam of light, is suitable for all applications where light needs to be projected from a long distance. The spot lamp can be used by the police, fire brigade, technical and emergency services. However, a spot lamp may also be useful in other special cases where a strong searchlight is required, for example in inland waterways for illuminating canals, locks, or landing stages.

**The spot lamp produces a narrow beam of light with high intensity, thereby illuminating a specific area at a long range.**

Luminous intensity in lux



## COMPACT 100

Floodlamp for H3 halogen bulb

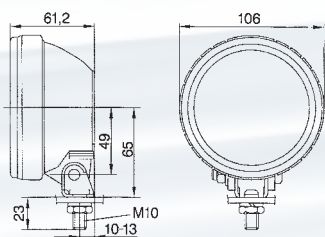

**Compact floodlamp for minimum installation space.**

### Technical features

Computer-designed reflector for increased luminous efficiency compared to conventional lamps of the same size.  
Bulb replacement from front made possible through bayonet fitting, service-friendly, tools not necessary.

### Headlamp housing

Glass-fiber-reinforced polyamide, matt-black surface, impact-resistant, unbreakable, and corrosion-proof.

### Light unit

Fluted lens bonded watertight to reflector.

### Mounting

Either upright, pendant or at the sides (offset 90°).

### Fastening

Swiveling, black chromated, corrosion protected M10 threaded bolt (not illustrated).

### Electrical connection

Two-pole. Blade terminals. Cable entry through integral rubber grommet.

### Scope of delivery

Single pack  
1 lamp with mounting parts.  
Order H3 halogen bulb separately.

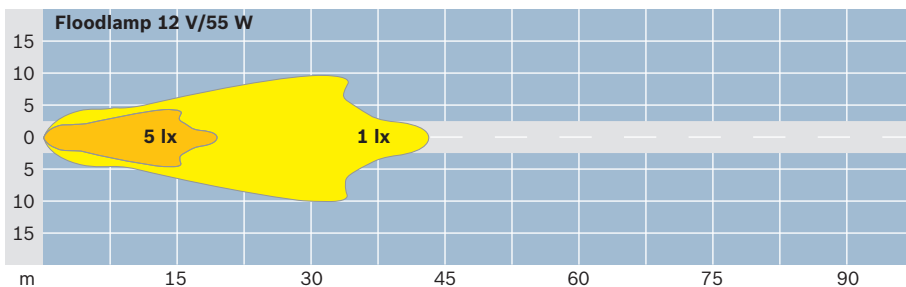

### COMPACT 100

Lens clear	0 306 055 101
------------	---------------

### Spare parts

Light unit	1 305 300 928
------------	---------------

### Bulb type

H3 12 V/55 W	1 987 302 ... *
--------------	-----------------



\* See chapter on "Headlamp bulbs" page A 64.

## COMPACT 100 Leisure

Floodlamp for H3 halogen bulb

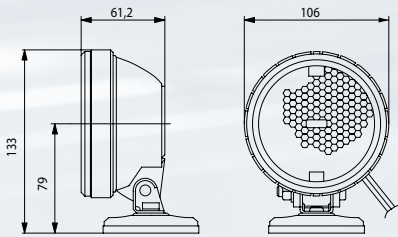

**Floodlamp with magnet mounting, 3.5 m (10 ft) spiral cable, and universal vehicle plug. Wide range of applications for hobby, leisure time, minor repairs, workshop.**

### Technical features

Computer-designed reflector for increased luminous efficiency compared to conventional lamps of the same size.  
Bulb replacement from front made possible through bayonet fitting, service friendly, tools not necessary.

### Headlamp housing

Glass-fiber-reinforced polyamide, matt-black surface, impact-resistant, unbreakable, and corrosion-proof.

### Light unit

Fluted lens bonded watertight to reflector.

### Mounting

Magnet dia. 71 mm, swivellable through 90°.

### Electrical connection

Lead 2 x 0.75 m, extended length 3.50 m,  
Connector, 2-pin for socket as under  
DIN ISO 4165 and car cigarette lighter

### Scope of delivery

In self-service pack. 1 lamp including H3 halogen bulb 12 V/35 W, magnet, 3.5 m (10 ft) spiral cable with universal plug, already assembled, ready for operation.

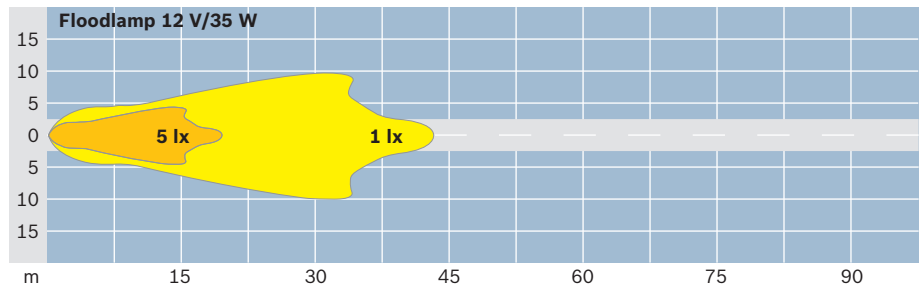

### COMPACT 100 Leisure

Lens clear **0 306 055 102**

### Spare parts

Light unit **1 305 300 928**

### Bulb type

**H3 12 V/35 W** Order externally

# 105

## Floodlamp for F2 bulb

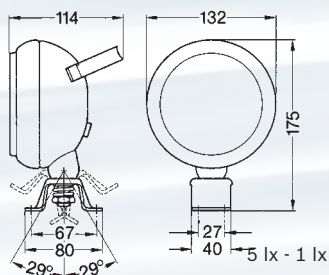

**Floodlamp 105 in steel version, with handle and switch, range 23 m.**

**Lamp housing**

Steel, black-resicoated, scratch and rust-resistant.

**Light unit**

Lens with rectangular fluting pattern.

**Mounting**

Upright.

**Fastening**

Rustproof swivel mounting bracket with 4 holes for M6 screws. Pivoting angle forward 29°, rearward 29°, sideward 315°.

**Electrical connection**

Single-pole (separate ground connection). Screw terminals. Cable entry through rubber grommet.

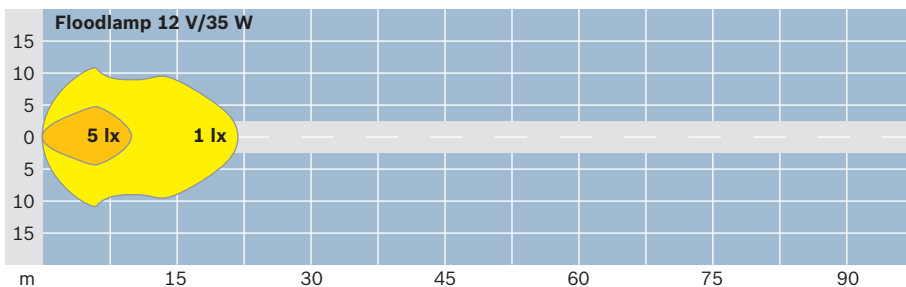

**ASW 105**

With handle and switch **0 306 181 009**

**Spare parts**

Lens	<b>1 305 600 030</b>
Gasket	<b>1 300 212 010</b>

**Bulb type**

<b>F2 BA20s</b> 12 V/35 W	Osram 7309
24 V/35 W	Osram 7409

## Kiruna 140

Floodlamp for H1 halogen bulb

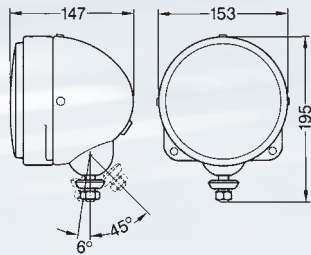

**Vibration-resistant floodlamp for heavy-duty service. Range 55 m (55 W), 70 m (100 W).**

### Lamp housing

Steel, black-resicoated, scratch and rust-resistant.

### Light unit

Lens with rectangular fluting. **Reflector with lens glued-on watertight** and with rubber ring, mounted vibration dampened in headlamp housing. This in turn reduces vibration transmission.

### Mounting

Optionally upright, pendant or horizontal.

### Fastening

Rustproof swivel-type threaded stud M12. Pivoting angle forward 6°, rearward 45°, sideways 360°.

### Electrical connection

Single-pole. Blade terminals. Cable entry through rubber grommet.

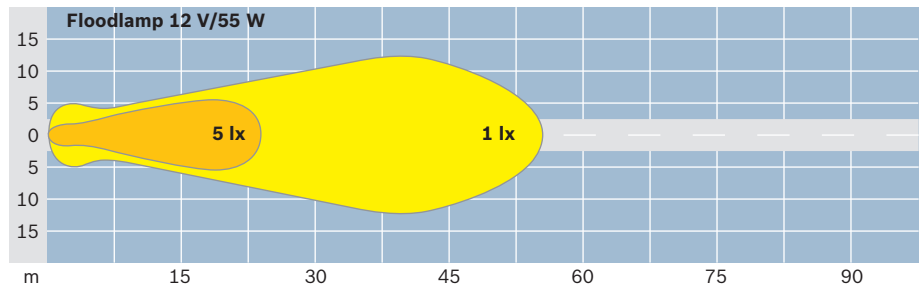

**Kiruna 140** **0 306 382 001**

### Spare parts

Light unit	<b>1 305 302 021</b>
Gasket	<b>1 301 015 115</b>
Housing with gasket	<b>1 305 122 901</b>

### Bulb type

<b>H1</b> 12 V/55 W	<b>1 987 302 011 *</b>
<b>H1</b> 12 V/100 W	<b>1 987 302 016</b>
<b>H1</b> 24 V/70 W	<b>1 987 302 411</b>

\* Alternative bulbs, see chapter on "Headlamp bulbs" page A 64.

# Pilot 140

Floodlamps or spot lamps for H3 halogen bulb

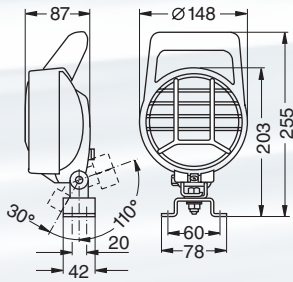

**Extremely watertight floodlamp, optionally available with and without practical handle and protective grille. Searchlight version with handle and protective grille. For heavy-duty service.**

**Lamp housing**

Fiberglass reinforced polyamide. Surface matt black. Impactresistant, corrosion-resistant, and unbreakable.

**Light unit**

Lens bonded watertight to reflector.

**Mounting**

Option of upright or suspended.

**Fastening**

Swivel corrosion-resistant mounting bracket with 4 holes for M6 screws.

**Swivelling range**

Forward 30°, rearward 110°, sideward 360°.

**Electrical connection**

Two-pole. Blade terminals. Cable entry through splashproof rubber grommet.

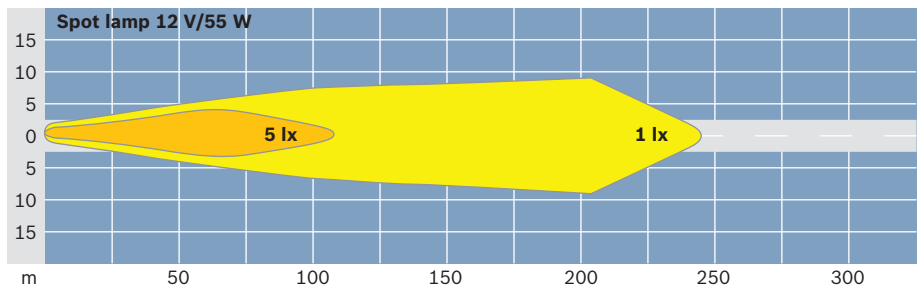
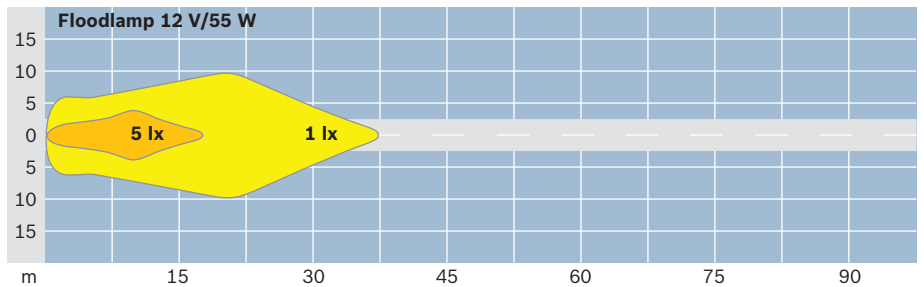

**Floodlamp Pilot 140**

**Range 37 m**

① Without handle, without guard	<b>0 306 481 001</b>
② With handle and guard	<b>0 306 481 004</b>

**Accessories (order separately)**

Guard without	
Handle (for...001)	<b>1 305 501 121</b>

**Spare parts**

Light unit	<b>1 305 301 918</b>
Hinged grommet	<b>1 300 312 010</b>
Mounting bracket	<b>1 307 022 236</b>

**Bulb type**

<b>H3 12 V/55 W</b>	<b>1 987 302 031 *</b>
<b>H3 24 V/70 W</b>	<b>1 987 302 431</b>

**Spot lamp Pilot 140**

**Range 240 m**

② With handle and guard	<b>0 306 481 003</b>
-------------------------	----------------------

**Spare parts**

Light unit	<b>1 305 301 917</b>
Hinged grommet	<b>1 300 312 010</b>
Mounting bracket	<b>1 307 022 236</b>

**Bulb type**

<b>H3 12 V/55 W</b>	<b>1 987 302 031 *</b>
<b>H3 24 V/70 W</b>	<b>1 987 302 431</b>

\* Alternative bulbs, see chapter on "Headlamp bulbs" page A 64.

## Pilot 145

Floodlamp for H3 halogen bulb

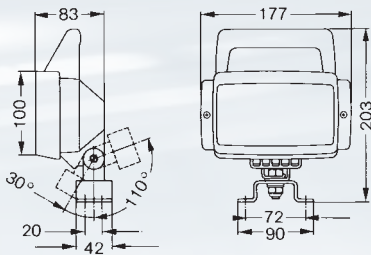

**Floodlamp for versatile areas of application.**  
Optionally available with and without handle.

### Lamp housing

Fiberglass reinforced polyamide. Surface matt black. Impact- and corrosion-resistant.

### Light unit

Lens bonded watertight to reflector.

### Mounting

Option of upright or suspended.

### Fastening

Swivel corrosion-resistant mounting bracket with 4 holes for M6 screws. Swivel corrosion-resistant mounting bracket with threaded stud M10.

### Swivelling range

Forward 30°, rearward 110°, sideward 360°.

### Electrical connection

Two-pole. Blade terminals. Cable entry through splashproof rubber grommet.

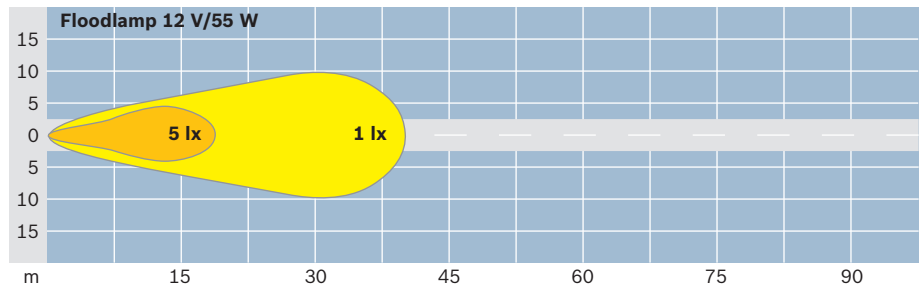

### Floodlamp Pilot 145

#### Range 40 m

With mounting bracket	0 306 482 001
① Without mounting bracket	0 306 482 010
② With handle, frame and mounting bracket	0 306 482 003

#### Spare parts

Light unit	1 305 354 911
Hinged grommet	1 300 312 010

#### Bulb type

H3 12 V/55 W	1 987 302 031 *
H3 24 V/70 W	1 987 302 431



\* Alternative bulbs,  
see chapter on "Headlamp bulbs" page A 64.

# Pilot 150

Floodlamp for H3 halogen bulb

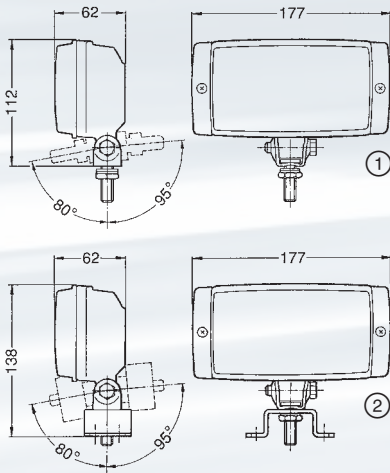

**Floodlamp with and without swiveling mounting bracket for flexible mounting. Multipurpose application spectrum. Optimum homogeneous light distribution.**

**Lamp housing**

Fiberglass-reinforced plastic, surface matt black.

**Light unit**

Interchangeable.

**Mounting**

Option of upright or suspended.

**Fastening**

Through swiveling fork holder to body or bumper.

**Swivelling range**

Forwards 80°, rearwards 95°, sideways 360°.

**Electrical connection**

With blade terminal and sleeve.

**Bulb type**

For H3 12 V/55 W and 24 V/70 W bulbs.

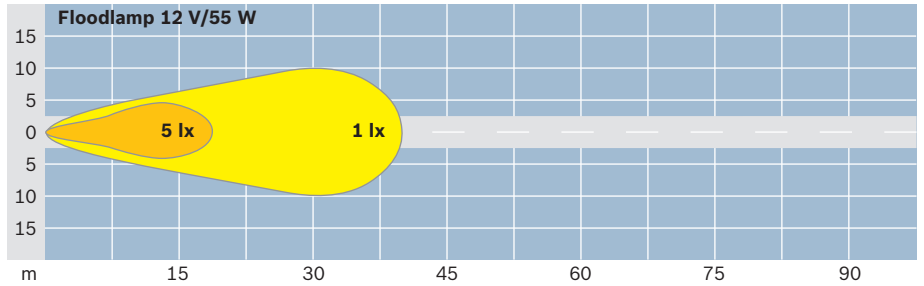

**① Pilot 150**

<b>Range 40 m</b>	<b>0 306 484 001</b>
-------------------	----------------------

**Spare parts**

Light unit	<b>1 305 354 911</b>
Holder for unit	<b>1 301 091 002</b>

**Bulb type**

<b>H3 12 V/55 W</b>	<b>1 987 302 031 *</b>
<b>H3 24 V/70 W</b>	<b>1 987 302 431</b>

**② Pilot 150 with Mounting bracket**

<b>Range 40 m</b>	<b>0 306 484 002</b>
-------------------	----------------------

**Spare parts**

Light unit	<b>1 305 354 911</b>
Holder for unit	<b>1 301 091 002</b>
Mounting bracket	<b>1 307 022 236</b>

\* Alternative bulbs, see chapter on "Headlamp bulbs" page A 64.

## Pilot 160

Floodlamp for H3 halogen bulb

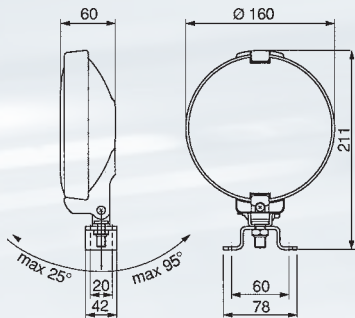

**Floodlamp with mounting bracket for flexible installation. Multipurpose application spectrum. Optimum homogeneous light distribution.**

### Lamp housing

Fiberglass-reinforced polyamide.  
Surface matt black.

### Light unit

Interchangeable.

### Mounting

Upright and suspended.

### Fastening

Through swiveling fork holder to body or bumper.

### Swivelling range

Forwards 25°, rearwards 95°, sideways 360°.

### Electrical connection

Cable feed through sleeve for single cores.

### Bulb type

For bulbs H3 12 V/55 W and 24 V/70 W.

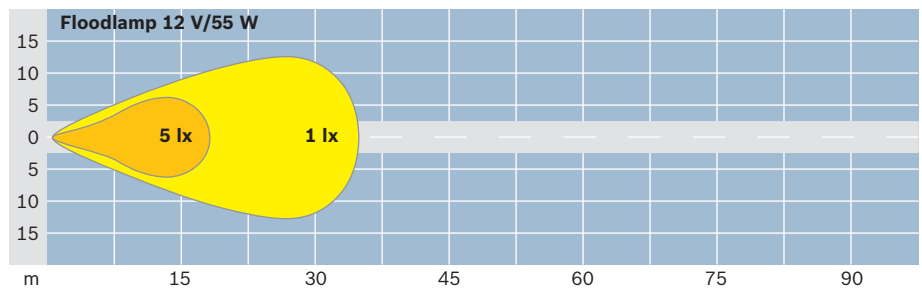

### Floodlamp Pilot 160

#### Range 35 m

**0 306 680 001**

#### Spare parts

Holder for unit **1 301 091 004**

Mounting bracket **1 307 022 236**

#### Bulb type

H3 12 V/55 W **1 987 302 031 \***

H3 24 V/70 W **1 987 302 431**

\* Alternative bulbs,  
see chapter on "Headlamp bulbs" page A 64.

# 140 x 65

## Floodlamp for standard bulb



### Mounting examples

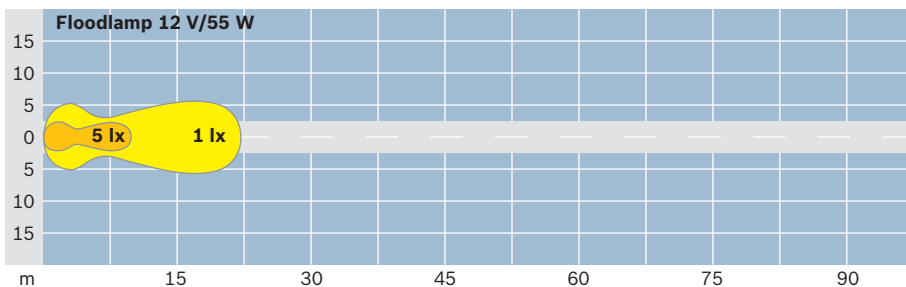
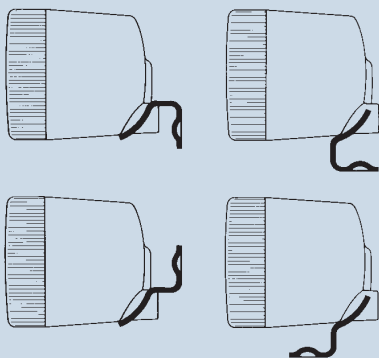

**Especially for minimum installation space and multipurpose fitting**

**Lamp housing**  
Plastic, embossed matt black.  
Reflector and lens made of plastic.

**Mounting**  
Upright or pendant as required on horizontal, vertical or inclined surfaces.

**Fastening**  
With adjustable, non-corrosive mounting bracket (2 brackets supplied).

**Electrical connection**  
Single-pole. Blade terminals. Cable entry through rubber grommet.

**Floodlamp 140 x 65**  
**Range 22 m**

**0 306 483 001**

**Spare parts**

Lens **1 305 620 054**

**Bulb type**

**P21W 12 V/25 W 1 987 302 201**

**P21W 24 V/25 W 1 987 302 501**

# Touring 140

Floodlamps and spot lamps for H3 halogen bulb

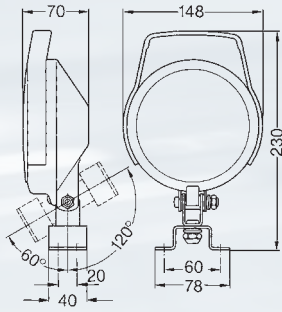

**With switch and handle for convenient regulation of swiveling range.**

**Lamp housing**

Steel, black-resicoated. Resistant to scratching and corrosion.

**Light unit**

Lens bonded watertight to reflector.

**Mounting**

Option of upright or suspended.

**Fastening**

Corrosion-protected swivel mounting bracket, with 4 holes for screws M6.

**Swivelling range**

Forwards 30°, rearwards 110°, sideways 360°.

**Electrical connection**

Single-pole (separate ground connection available). Blade terminals. Cable entry through rubber grommet.

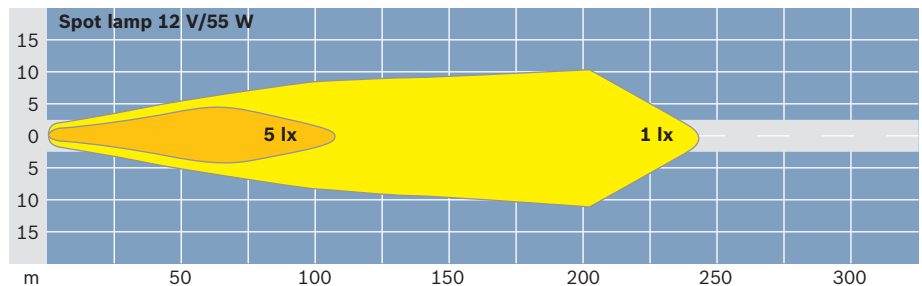
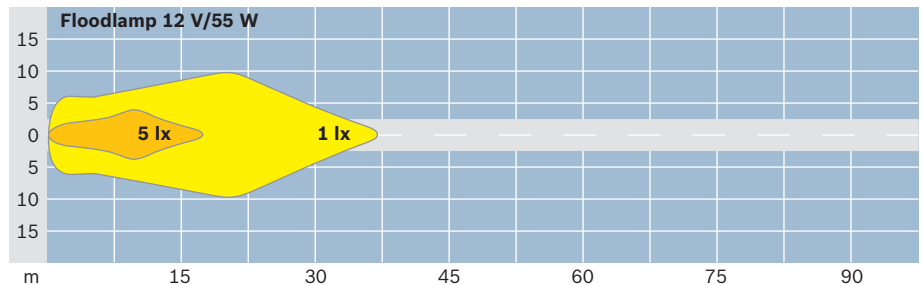

① **Floodlamp Touring 140**

**Range 37 m**

With handle and switch **0 306 480 002**

**Spare parts**

Light unit **1 305 301 918**

Mounting bracket **1 307 022 236**

**Bulb type**

H3 12 V/55 W **1 987 302 031**

H3 24 V/70 W **1 987 302 431**

② **Spot lamp Touring 140**

**Range 240 m**

With handle and switch **0 306 480 001**

**Spare parts**

Light unit **1 305 301 917**

Mounting bracket **1 307 022 236**

**Bulb type**

H3 12 V/55 W **1 987 302 031 \***

H3 24 V/70 W **1 987 302 431**

\* Alternative bulbs, see chapter on "Headlamp bulbs" page A 64.

# Touring 190

Floodlamps and spot lamps for H3 halogen bulb

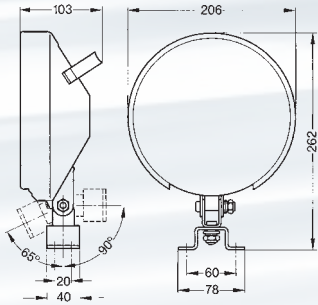

**Searchlight version with surrounding illumination – with and without handle and switch.**

**Lamp housing**

Steel, black-resicoated, resistant to scratching and corrosion.

**Light unit**

Lens bonded watertight to reflector.

**Mounting**

Option of upright or suspended.

**Fastening**

Corrosion-protected swivel mounting bracket, with 4 holes for screws M6.

**Swivelling range**

Forwards 65°, rearwards 90°, sideways 360°.

**Electrical connection**

Single-pole (separate ground connection available). Blade terminals. Cable entry through rubber grommet

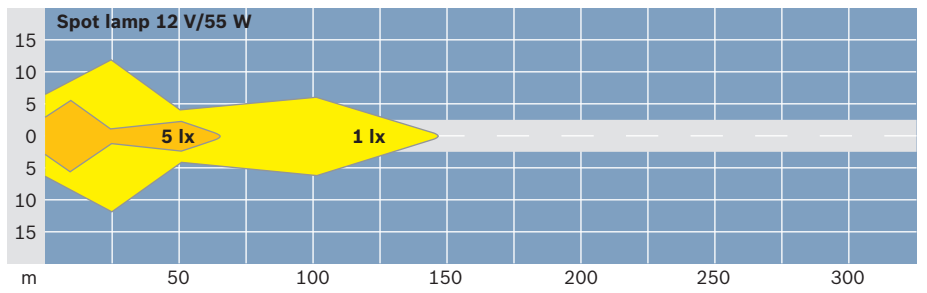
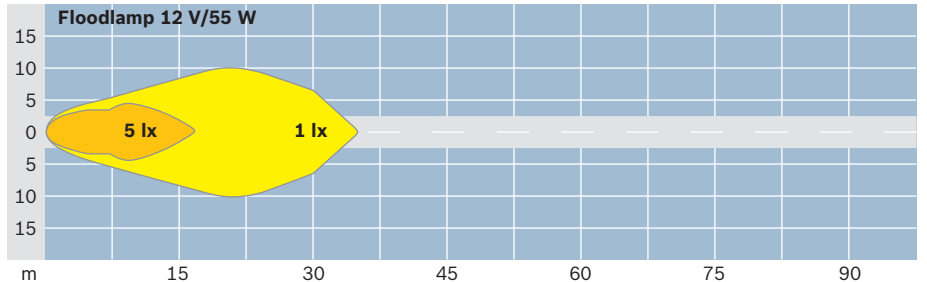

**① Floodlamp Touring 190**

<b>Range</b>	
With 55-W-H3-Bulbs	<b>35 m</b>
With 100-W-H3-Bulbs	<b>54 m</b>
With handle and switch	<b>0 306 980 002</b>
Without handle and switch	<b>0 306 980 003</b>

**Spare parts für ① ②**

Light unit for 0 306 980 002/003	<b>1 305 313 935</b>
for 0 306 980 004	<b>1 305 313 937</b>
Mounting bracket	<b>1 307 022 236</b>

**Bulb type**

<b>H3 12 V/55 W</b>	<b>1 978 302 031 *</b>
<b>H3 12 V/100 W</b>	<b>1 978 302 036</b>
<b>H3 24 V/70 W</b>	<b>1 978 302 431</b>

**② Spot lamp Touring 190**

**with floodlight effect in immediate vicinity**

<b>Range</b>	
With 55-W-H3-Bulbs	<b>145 m</b>
With 100-W-H3-Bulbs	<b>205 m</b>
With handle and switch	<b>0 306 980 004</b>

\* Alternative bulbs, see chapter on "Headlamp bulbs" page A 64.

## Profi 210

Floodlamp for H3 halogen bulb

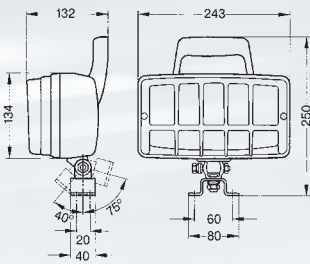

Particularly robust – with protective grille made of impact-resistant plastic. Optionally available with handle and switch.

### Lamp housing

Steel, black-resincoated. Resistant to scratching and corrosion. Outer rim and guard manufactured from fiberglass-reinforced polyamide, matt black, impact-resistant and unbreakable.

### Light unit

Lens bonded watertight to reflector.

### Mounting

Upright and pendant.

### Fastening

Corrosion-protected swivel mounting bracket with 4 holes for screws M6.

### Swivelling range

Forwards 40°, rearwards 75°, sideways 360°.

### Electrical connection

Single-pole (separate ground connection available). Blade terminals. Cable entry through rubber grommet

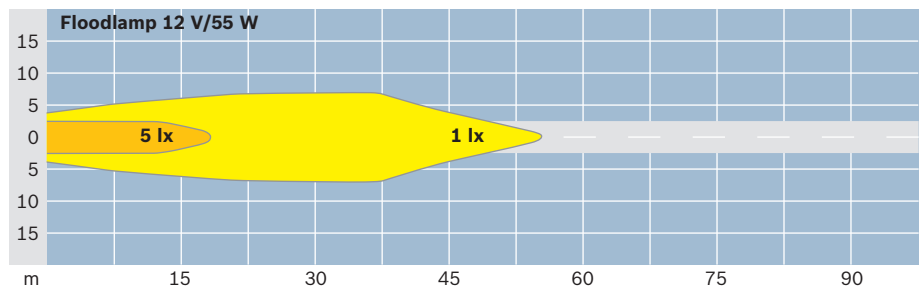

### Floodlamp Profi 210 with guard

#### Range

With 55-W-H3-Bulbs **55 m**

With 100-W-H3-Bulbs **80 m**

With handle and switch **0 306 080 002**

Without handle, without switch **0 306 080 003**

### Spare parts

Outer rim	<b>1 305 540 932 *</b>
Guard	<b>1 305 540 933</b>
Mounting bracket	<b>1 307 022 236</b>

### Bulb type

H3 12 V/55 W	<b>1 978 302 031 **</b>
H3 12 V/100 W	<b>1 978 302 036</b>
H3 24 V/70 W	<b>1 978 302 431</b>

\* As long as stocks last.

\*\* Alternative bulbs, see chapter on "Headlamp bulbs" page A 64.

